

### RELATED STANDARDS

FAA AC 150/5345-46 L-862S FAA-E-982  
ICAO Annex 14 Vol. I Para. 5.3.4  
IEC TS 61827  
STANAG 3316

### APPLICATIONS

- As high intensity approach centerline, crossbar and side row light in CAT I, II & III conditions
- As high intensity threshold, threshold wing bar, runway end and stop bar light in CAT I, II and III conditions
- As heliport flood light with visor

### IMPORTANT FEATURES

- IEC TS 61827 certified
- Easily mounted with breakable coupling over a 2" conduit elbow.
- Needs no maintenance with its aluminium body and optics, temperature resistant wiring, gasket and front glass and stainless steel screws
- Lamp changed from the back easily without removing the reflector and front glass. PK30d quartz halogen, prefocused lamp needs no special equipment to be changed
- Optical adjustment is done easily by two screws
- Long lamp life uses 200 W lamp for threshold, 150W for approach , 100W for runway end and 45W for stop bar

### ELECTRICAL SUPPLY

Through a 45 W, 100 W, 150 W or 200 W isolating transformer.

### OPTICAL PERFORMANCE

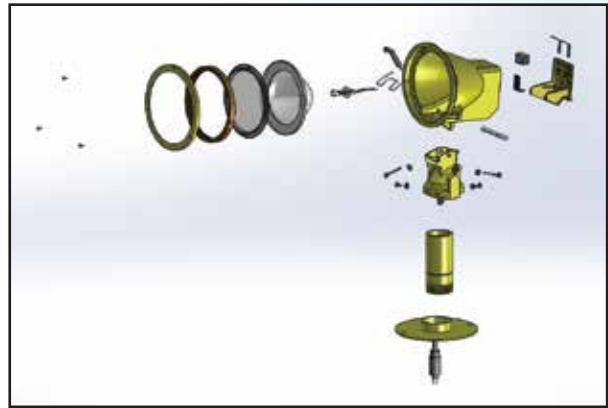
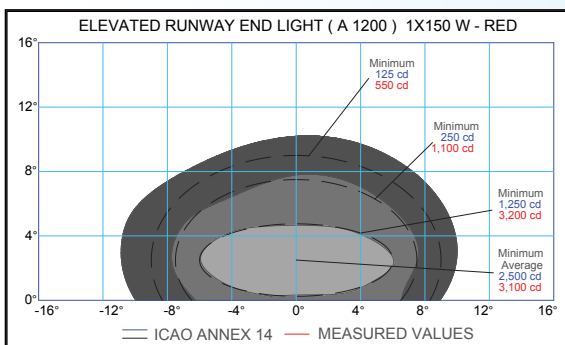
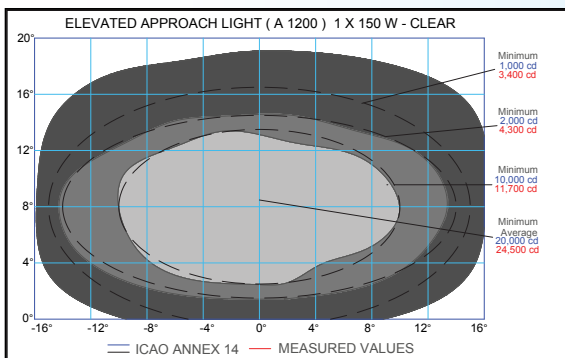

### CONSTRUCTION

1. Front ring
2. Heat resistant gasket
3. Front glass
4. Anodized specular reflector
5. PK30d quartz halogen, prefocused lamp
6. Heat resistant internal wiring
7. Electrical connectors
8. Upper body and lamp holder, die-cast aluminium
9. Back cover
10. Space for short circuit relay
11. Screws for angle adjustment
12. Lower body, die-cast aluminium
13. Breakable coupling
14. 2-pole plug to FAA L-823 with heat resistant wires

### MATERIALS & FINISH

Chromate treatment and electrostatic powder coating. The color is aviation yellow and hardware is made of stainless steel.

### WEIGHT

With the inner lenses, Net weight is 1,95 kg.

### PACKING INFO

In cardboard boxes of 21 x 18,5 x 30 cm.