

RELATED STANDARDS

FAA AC 150/5345-46 L-850D
ICAO Annex 14 Vol. I Para. 5.3.10 5.3.11
IEC TS 61827
STANAG 3316

APPLICATIONS

- As bidirectional high intensity combined threshold and runway end light in CAT I, II & III conditions
- As unidirectional high intensity threshold or runway end light in CAT I, II & III conditions

IMPORTANT FEATURES

- ETL Certified  (L850D-RTEL-3-1-105G)
- IEC TS 61827 Certified
- Member of an extensive range of FAA Approved 12 inch diameter inset lights
- Equipped with three or two 105 W 6,6 A halogen pre-focused reflector lamps
- Long lamp life 1000 hours at full intensity (6.6 A) increases to 2000-4000 hours in practice as the light usually operates at lower intensities
- Needs very little maintenance with its aluminium body and optics, high temperature resistant wiring, gasket and front glass and stainless steel screws
- Lamp can be changed from the back easily without removing the reflector and front glass, no special equipment is needed
- Optical adjustment is done easily by two screws
- Low rising smooth outer surface
- Can be installed directly on a 12 inch shallow base, on a L-868 Size B deep base or by means of an adapter ring on a L-868 Size C deep base

ELECTRICAL SUPPLY

- Through,
- One 300 W isolating transformer (bidirectional) or
 - One 100 W or one 200 W isolating transformer (unidirectional)

PHOTOMETRIC PERFORMANCE

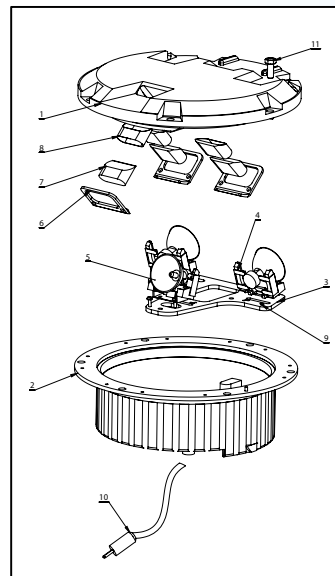
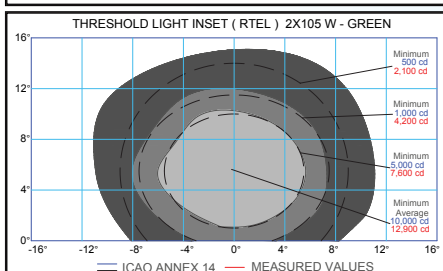
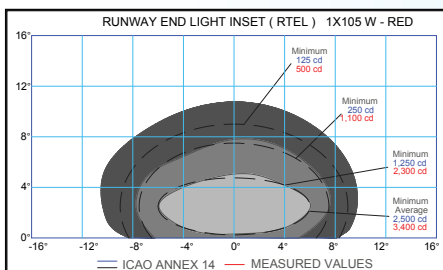

CONSTRUCTION

1. Forged aluminium cover
2. Cast aluminium inner cover
3. Optical assembly
4. Lamp holder
5. 105 W prefocus halogen lamps
6. Prism retainer
7. Prism
8. Prism gasket
9. Optical adjustment screws
10. 2 pole FAA L-823 plug
11. Screw with washer

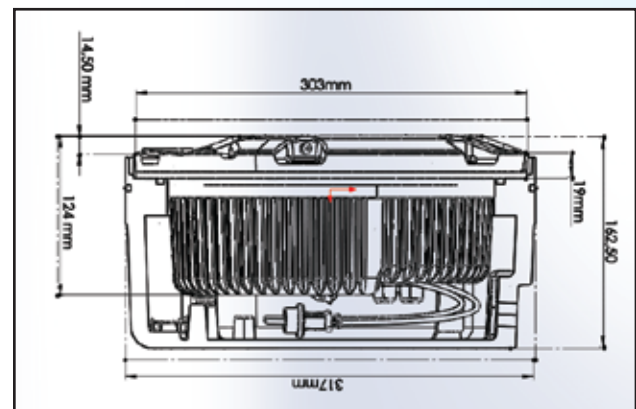

MATERIALS & FINISH

Aluminium alloy cover, inner cover and optical assembly. Hardware is made of stainless steel.

WEIGHT

Net weight is 8,2 kg.

PACKING INFO

In cardboard boxes of 33 x 33 x 16,5 cm.